

**OGLE0572****OPTICAL SENSORS • FORK LIGHT BARRIERS**

Special design of through-beam sensor. Transmitter and receiver are located in the fork or angular limbs and are perfectly aligned to each other.

**MECHANICAL DATA**

|                                             |               |
|---------------------------------------------|---------------|
| Ambient temperature (MAX)                   | 60 °C         |
| Ambient temperature (MIN)                   | -25 °C        |
| Degree of protection (IP)                   | IP67          |
| Fork depth                                  | 110 mm        |
| Fork light barrier design                   | Furcate       |
| Fork width                                  | 250 mm        |
| Housing design                              | Cuboid        |
| Housing material                            | Zinc die-cast |
| Material of optical surface                 | Glass         |
| Reflector included in the scope of delivery | No            |
| Sensor height                               | 274 mm        |
| Sensor length                               | 12 mm         |
| Sensor width                                | 140 mm        |

**ELECTRICAL DATA**

|                                                |        |
|------------------------------------------------|--------|
| Analogue output 0 mA ... 20 mA                 | No     |
| Analogue output 0 V ... 10 V                   | No     |
| Analogue output -10 V ... +10 V                | No     |
| Analogue output 4 mA ... 20 mA                 | No     |
| Decay time                                     | 0.1 ms |
| Hysteresis                                     | 0.1 mm |
| IO-Link compatible                             | Yes    |
| Max. output current                            | 100 mA |
| Max. switching distance                        | 250 mm |
| No-load current                                | 30 mA  |
| Number of pins                                 | 3      |
| Operating voltage (MAX)                        | 30 V   |
| Operating voltage (MIN)                        | 10 V   |
| Pre-failure message                            | No     |
| Rated control supply voltage $U_s$ at DC (MAX) | 30 V   |
| Rated control supply voltage $U_s$ at DC (MIN) | 10 V   |

**ELECTRICAL DATA**

|                                                |                                               |
|------------------------------------------------|-----------------------------------------------|
| Relative repeat accuracy                       | 0.03 mm                                       |
| Repeatability +/-                              | 30 µm                                         |
| Response time                                  | 0.1 ms                                        |
| Reverse polarity protection                    | Yes                                           |
| Scanning function                              | Light-/dark-on mode                           |
| Setting procedure                              | Manual adjustment                             |
| Short-circuit-proof                            | Yes                                           |
| Suitable for safety functions                  | No                                            |
| Switching frequency                            | 5000 Hz                                       |
| Type of electrical connection                  | Connector M8                                  |
| Type of switching function                     | Normally closed contact/normally open contact |
| Type of switching output                       | PNP/NPN                                       |
| Type of the forked light barrier               | Standard                                      |
| Voltage drop                                   | 2.8 V                                         |
| Voltage type                                   | DC                                            |
| With communication interface, analog           | No                                            |
| With communication interface, AS-Interface     | No                                            |
| With communication interface, CANOpen          | No                                            |
| With communication interface, DeviceNet        | No                                            |
| With communication interface, Ethernet         | No                                            |
| With communication interface, INTERBUS         | No                                            |
| With communication interface, PROFIBUS         | No                                            |
| With communication interface, RS-232           | No                                            |
| With communication interface, RS-422           | No                                            |
| With communication interface, RS-485           | No                                            |
| With communication interface, SSD              | No                                            |
| With communication interface, SSI              | No                                            |
| With monitoring function of downstream devices | No                                            |
| With other analog output                       | No                                            |
| With restart lock                              | No                                            |
| With time function                             | No                                            |

**OPTICAL DATA**

|                          |                         |
|--------------------------|-------------------------|
| Laser protection class   | None                    |
| Light beam form          | Point                   |
| Light source             | Polarity free red light |
| Min. object size         | 1 mm                    |
| Resolution               | 1000 µm                 |
| Wavelength of the sensor | 660 nm                  |

**OTHER DATA**

|                    |     |
|--------------------|-----|
| Feeding technology | Yes |
|--------------------|-----|

**CONNECTION**

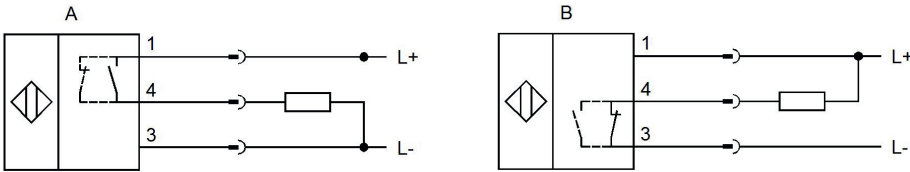

**Colors:** A: 1 = BN (brown), 3 = BU (blue), 4 = BK (black)  
 B: 1 = BN (brown), 3 = BU (blue), 4 = BK (black)  
**Functions:** A: 1 = L+, 3 = L-, 4 = PNP NO/NC  
 B: 1 = L+, 3 = L-, 4 = NPN NC/NO

**DIMENSIONAL DRAWING**

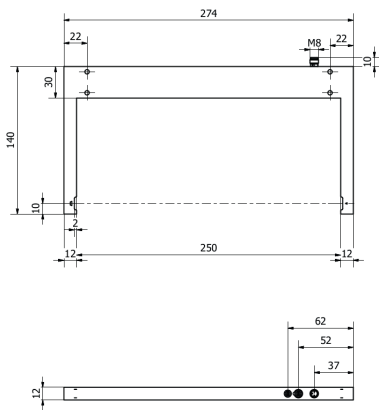

**INSTALLATION**



Mounting / Installation may only be carried out by a qualified electrician!

**DISPOSAL**



**SAFETY WARNINGS**

Before initial operation, please make sure to follow all safety instructions that may be provided in the product information!

Never use these devices in applications where the safety of a person depends on their functionality.