

SS916021**FLOW SENSORS • SENSORS FOR WATER**

The function of the flow sensor is based on the calorimetric principle. The probe is heated up from the inside a few degrees Celsius in relation to the flow medium, in which it protrudes. When the medium flows, the heat generated in the probe is dissipated through the medium. The temperature within the sensor is measured and compared with the likewise measured medium temperature. From the obtained temperature difference the flow state of each medium can be derived. These sensors are applied in areas such as monitoring of cooling systems, ventilation systems, pump dry running by checking the presence of liquid or gas flows.

MECHANICAL DATA

Medium temperature	-20 °C ... 80 °C
Pressure resistance	100 bar
Sensing element material	Stainless steel 1.4571
Type of process connection	G3/4 inch

ELECTRICAL DATA

Adjustable responding value for flow for liquids	0.03 m/s ... 3 m/s
Flow range for water	1.5 m/s
Flow range for water	0.01 m/s
IO-Link compatible	No
Pressure resistance of measuring head	100 bar
Readiness delay	15 ms
Turn-off delay	15 s

OTHER DATA

For hydraulic applications	Yes
Suitable for gases	No
Suitable for liquids	No

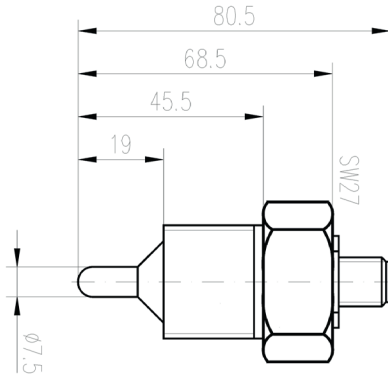
DIMENSIONAL DRAWING**INSTALLATION**

Mounting / Installation may only be carried out by a qualified electrician!

DISPOSAL**SAFETY WARNINGS**

Before initial operation, please make sure to follow all safety instructions that may be provided in the product information!