

## sensor inductive, ATEX zone 20

**PRODUCT:** inductive proximity switch  
Atex zone 20

**DESIGN:** M18x1, flush-mounting

- certification DMT 01 ATEX E 157
- EX II 2G EEx m II T4
- intrinsic dust safety
- stainless steel housing



### technical data

operating voltage $U_B$	10 .. 30 VDC
nominal sensing range $S_n$	5mm
switching frequency	2kHz
output	PNP no/nc
max. output current	2 x 200mA
voltage drop	2.5 V
residual ripple max.	10%
current consumption (w/o. Load)	typ. 15mA
ambient temperature	-20 ... +90°C
status display	LED green/yellow
short circuit and reverse polarity protection	yes
system of protection	IP67
electrical connection	2m cable
housing material	nickel-plated brass
active face	PTFE

### electrical connection

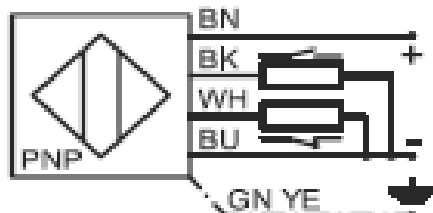

### dim. drawing

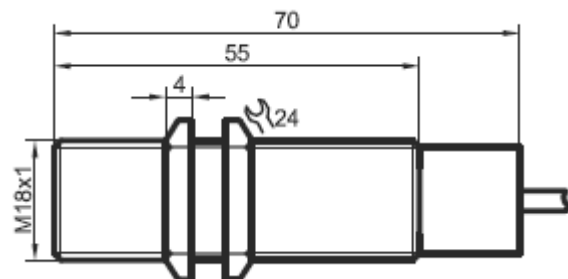

article code: **IB 18 A6 39**

**WARNING:** Never use these devices in applications where the safety depends on their functionality!