

IB300026

INDUCTIVE SENSORS • DISTANCE MEASUREMENT

Inductive proximity switches are contact-free sensors. They detect all conductive metals, regardless of whether they move or not. The achievable sensing range of the devices depends on the object material and its dimensions. The vibration-resistant sensors can be approached laterally or frontally. Inductive proximity switches are used for presence detection (e.g. goods carriers), positioning (e.g. dampers), counting (e.g. nuts /bolts), speed detection (e.g. for cog wheels), on conveyor systems (e.g. hose feedings) or distance measurements (e.g. press-in checking) of metallic objects.

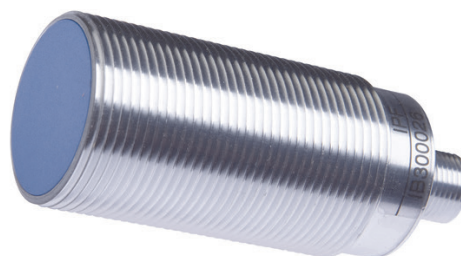

MECHANICAL DATA

| | |
|--|------------------------|
| Active area material of sensor | PBTP |
| Ambient temperature (MAX) | 70 °C |
| Ambient temperature (MIN) | -25 °C |
| Cable length | 0.3 m |
| Degree of protection (IP) | IP67 |
| Housing coating | Chromium-plated |
| Housing design | Cylinder, screw-thread |
| Housing material | Brass |
| Mechanical mounting condition for sensor | Flush |
| Number of wires | 3 |
| Sensor length | 73.5 mm |
| Thread pitch | 1.5 mm |
| Thread size, metric | 30 |
| Wire cross section | 0.14 mm ² |

ELECTRICAL DATA

| | |
|-------------------------------|-------------------------------|
| Absolute repeat accuracy | 0.03 mm |
| Distance measuring sensors | Yes |
| Measuring range length (MAX) | 20 mm |
| Measuring range length (MIN) | 0 mm |
| No-load current | 5 mA |
| Operating voltage (MAX) | 30 V |
| Operating voltage (MIN) | 15 V |
| Residual ripple | 10 % |
| Reverse polarity protection | Yes |
| Supply voltage (MAX) | 30 V |
| Supply voltage (MIN) | 15 V |
| Type of analog output | 0 V ... 10 V / 4 mA ... 20 mA |
| Type of electrical connection | Connector M12 |
| Voltage type | DC |

OTHER DATA

Relative linearity deviation

5 %

CONNECTION

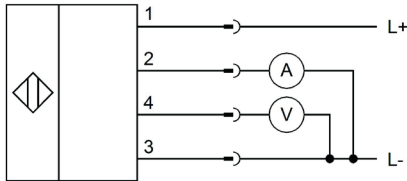

Colors: 1 = BN (brown), 2 = WH (white), 3 = BU (blue), 4 = BK (black)

Functions: 1 = L+, 2 = 4-20mA, 3 = L-, 4 = 0-10V

DIMENSIONAL DRAWING

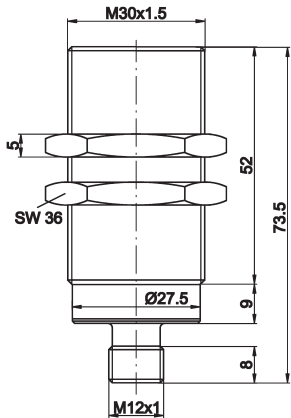

INSTALLATION



Mounting / Installation may only be carried out by a qualified electrician!

DISPOSAL



SAFETY WARNINGS

Before initial operation, please make sure to follow all safety instructions that may be provided in the product information!

Never use these devices in applications where the safety of a person depends on their functionality.